

# Rod End Alignment Coupler Inch Sizes

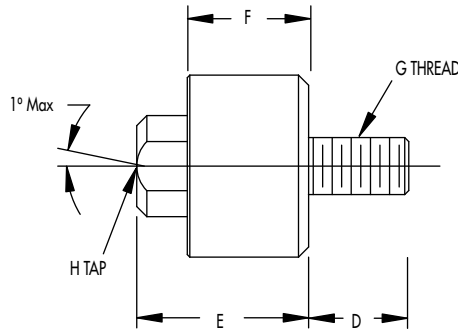
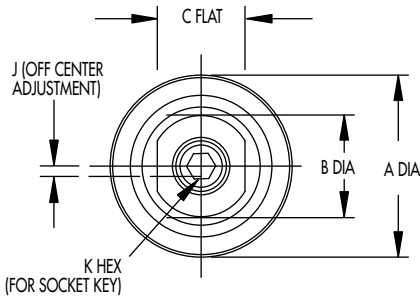

**Material:** Hardened steel  
**Finish:** Black Oxide Finish  
**Maximum Temperature Rating:** 200°F (93.3°C)

NOTE: Do not use alignment couplers on pivoting applications.

**Sold separately - Not attached to the cylinder.**

All dimensions are in inches.

Applicable Compact Air Cylinders	Screw Size	Part Number	Male Thread	Female Thread	A	B	C	D	E	F	G Male Thread	H Female Thread x Depth	J	K	Unit Weight (oz.)	Axial Load Ratings (lbs.)
1/2"	# 8	ACCC8	Coarse		9/16	1/4	7/32	5/16	7/16	11/32	# 8-32	#8-32 x 1/4	1/64	5/64	0.4	180
3/4"	#10	ACCC10	Coarse		9/16	5/16	1/4	11/32	9/16	13/32	# 10-24	#10-24 x 5/16	1/64	3/32	0.5	180
		ACCF10	Coarse	Fine							# 10-24	#10-32 x 5/16				
		ACFF10	Fine								# 10-32	#10-32 x 5/16				
		ACFC10	Fine	Coarse							# 10-32	#10-24 x 5/16				
-	1/4"	ACCC14	Coarse		15/16	1/2	7/16	13/32	13/16	9/16	1/4-20	1/4-20 x 1/2	1/32	1/8	1.6	450
		ACCF14	Coarse	Fine							1/4-20	1/4-28 x 1/2				
1-1/8"	5/16"	ACCC516	Coarse		15/16	1/2	7/16	11/16	13/16	9/16	5/16-18	5/16-18 x 5/8	1/64	5/32	1.6	580
		ACCF516	Coarse	Fine							5/16-18	5/16-24 x 5/8				
		ACFF516	Fine								5/16-24	5/16-24 x 5/8				
		ACFC516	Fine	Coarse							5/16-24	5/16-18 x 5/8				
1-1/8"	5/16"	ACCC516L	Coarse		1-1/8	5/8	9/16	9/16	1-1/32	3/4	5/16-18	5/16-18 x 5/8	1/32	5/32	3.2	580
		ACCF516L	Coarse	Fine							5/16-18	5/16-24 x 5/8				
		ACFF516L	Fine								5/16-24	5/16-24 x 5/8				
		ACFC516L	Fine	Coarse							5/16-24	5/16-18 x 5/8				
1-3/8" 1-5/8" 2.0"	3/8"	ACCC38	Coarse		1-1/8	5/8	9/16	19/32	1-1/32	3/4	3/8-16	3/8-16 x 5/8	1/32	3/16	3.2	830
		ACCF38	Coarse	Fine							3/8-16	3/8-24 x 5/8				
		ACFF38	Fine								3/8-24	3/8-24 x 5/8				
		ACFC38	Fine	Coarse							3/8-24	3/8-16 x 5/8				
2-1/2" 3.0" 4.0" 5.0"	7/16"	ACCF716	Coarse	Fine	1-9/16	3/4	11/16	3/4	1-3/8	1-1/8	1/2-13	7/16-20 x 13/16	1/16	1/4	8.8	1690
	ACFF716	Fine		1/2-20							7/16-20 x 13/16					
	1/2"	ACCC12	Coarse		1-9/16	3/4	11/16	3/4	1-3/8	1-1/8	1/2-13	1/2-13 x 13/16	1/16	1/4	8.8	1690
		ACCF12	Coarse	Fine							1/2-13	1/2-20 x 13/16				
ACFF12		Fine		1/2-20							1/2-20 x 13/16					
ACFC12		Fine	Coarse	1/2-20							1/2-13 x 13/16					
6.0" 8.0"	5/8"	ACCC58	Coarse		2-1/4	1.0	15/16	15/16	1-3/4	1-1/2	5/8-11	5/8-11 x 1.0	1/16	5/16	24.0	3220
		ACCF58	Coarse	Fine							5/8-11	5/8-18 x 1.0				
		ACFF58	Fine								5/8-18	5/8-18 x 1.0				
		ACFC58	Fine	Coarse							5/8-18	5/8-11 x 1.0				

# Rod End Alignment Coupler Combination Sizes

FIRST ANGLE PROJECTION

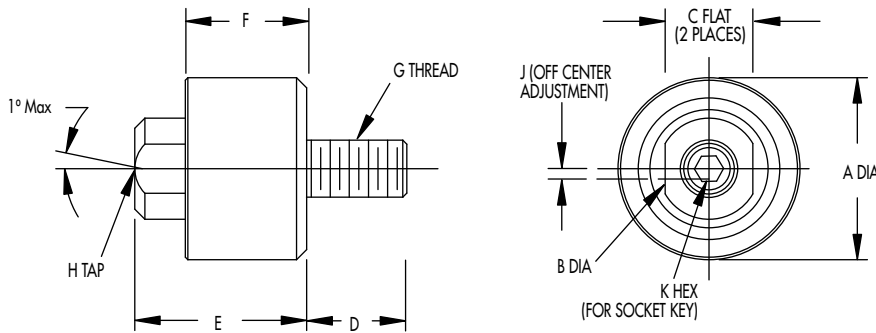

**Material:** Hardened steel  
**Finish:** Black Oxide Finish  
**Maximum Temperature Rating:** 200°F (93.3°C)

NOTE: Do not use alignment couplers on pivoting applications.

**Sold separately - Not attached to the cylinder.**

All dimensions are in millimeters except where noted.

Applicable Compact Air Cylinder	Part Number	A	B	C	D	E	F	G Male Thread	H Female Thread X Depth	J	K mm (Inch)	Unit Weight (Grams)	Axial Load Rating (N)
1/2" & 10mm	WACC8-M4	14,3	6,1	5,0	8,0	11,2	8,7	#8-32	M4x0,7 x 6		1,98 (5/64)		
10mm	WACM4-C8	14,0	6,35	5,6	6,0	12,5	10,0	M4x0,7	#8-32 x 1/4	0,4	2,5 (.098)	11,4	815
3/4"	WACC10-M5	14,3	7,6	7,0	8,7	14,5	10,3	#10-24	M5x0,8 x 8		2,38 (3/32)		
	#10-32												
20mm	WACM5-C10	14,0	7,9	6,35	8,0	15,2	11,0	M5x0,8	#10-24 x 5/16	0,4	3,0 (.118)	14,2	815
25mm	WACM5-F10								#10-32 x 5/16				
-	WACC14-M6	23,8	12,4	10,0	10,3	20,8	14,3	1/4-20	M6x1 x 13		3,18 (1/8)		
40mm	WACM6-C14	24,0	12,7	11,1	9,7	21,5	15,0	M6x1	1/4-20 x 1/2	0,8	4,0 (.157)	45,4	2045
	WACM6-F14								1/4-28 x 1/2				
1-1/8"	WACC516-M8	23,8	12,4	10,0	17,5	20,8	14,3	5/16-18	M8x1,25 x 13		3,97 (5/32)		
	WACF516-M8							5/16-24					
-	WACM8-C516	24,0	12,7	11,1	11,7	22,5	16,0	M8x1,25	5/16-18 x 5/8	0,4	5,0 (.197)	45,4	2580
	WACM8-F516								5/16-24 x 5/8				
1-3/8 1-5/8 2.0"	WACC38-M10	28,6	15,6	13,0	15,1	26,3	19,1	3/8-16	M10x1,5 x 15		4,76 (3/16)		
	WACF38-M10							3/8-24					
-	WACM10-C38	28,0	15,9	14,3	16	26,5	20,0	M10x1,5	3/8-16 x 5/8	0,8	7,0 (.276)	90,7	3700
	WACM10-F38								3/8-24 x 5/8				
2-1/2 3.0 4.0 5.0"	WACM12-F716	39,0	19,1	17,5	17,9	36,5	30,0	M12x1,75	7/16-20 x 13/16		8,0 (.315)		
	WACC12-M12	39,7	18,8	16,0	19,1	35,1	28,6	1/2-13	M12x1,75 x 19		6,35 (1/4)		
	WACF12-M12							1/2-20					
	WACM12-C12	39,0	19,1	17,5	17,9	36,5	30,0	M12x1,75	1/2-13 x 13/16	1,6	8,0 (.315)	250,0	7540
WACM12-F12	1/2-20 x 13/16												

